

ELEVATION

SECTION

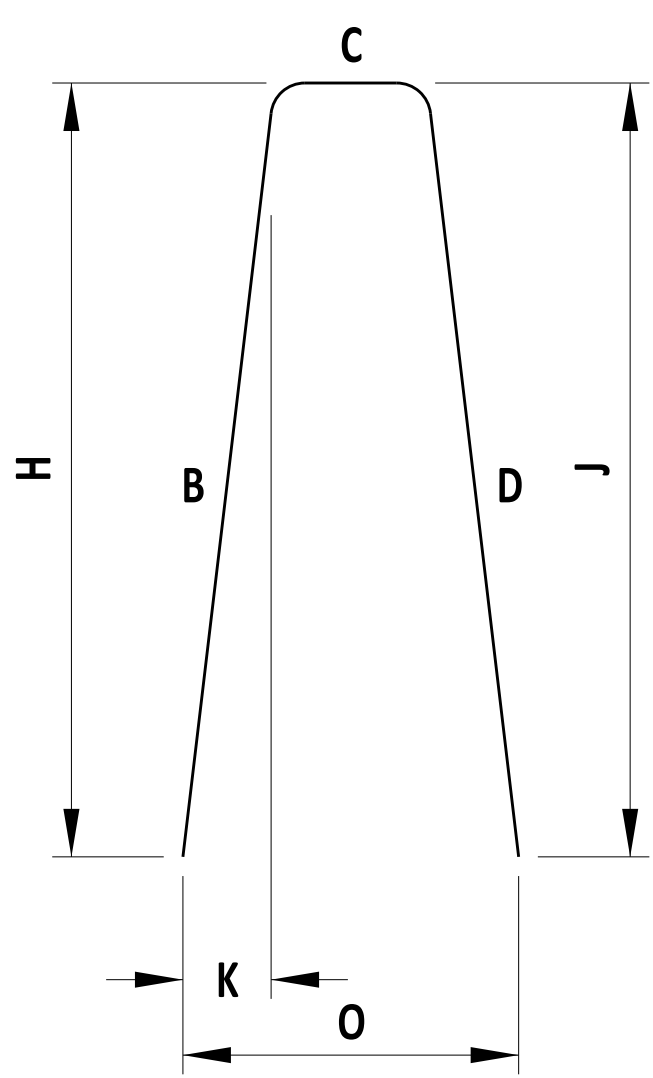

TYPE DE10 BAR

BAR SCHEDULE											
MARK	SIZE	NUMBER PER 20' SECTION *	LENGTH *	TYPE	B	C	D	H	K	J	O
4B1E	4	29	6'-9 1/4"	DE10	3'-2 1/4"	6"	3'-2 1/4"	3'-2"	4"	3'-2"	1'-2"
5B2E	5	8	19'-8"	STR.							

* NUMBER OF 4B1E BARS AND LENGTH OF 5B2E BARS GIVEN FOR 20'-0" SECTIONS. NUMBER AND LENGTH OF BARS SHALL BE ADJUSTED ACCORDINGLY FOR SECTION LENGTHS BETWEEN 10'-0" AND 20'-0".

- NOTES:**
- 1). CONCRETE CLEAR COVER FOR REINFORCEMENT BARS SHALL BE 2" MINIMUM, UNLESS OTHERWISE NOTED.
 - 2). BARRIER CONTRACTION JOINTS OVER EXISTING PAVEMENT CONTRACTION JOINTS SHALL BE SEPARATED BY OPEN JOINTS HAVING THE SAME WIDTH AS THE PAVEMENT JOINTS FOR THE FULL EXPOSED SURFACE OF THE BARRIER.
 - 3). BARRIER CONTRACTION JOINTS SHALL BE A GROOVE 1/8" WIDE AND 1/2" DEEP, SAWED OR FORMED ACROSS THE TOP AND ALONG THE SIDES FOR THE ENTIRE SURFACE OF THE BARRIER, OR A FULL DEPTH BUTT JOINT, AT APPROXIMATELY 10'-0" TO 20'-0" INTERVALS ALONG THE LENGTH OF THE BARRIER. IN ADDITION, THESE GROOVED OR BUTT JOINTS SHALL TRANSVERSELY ALIGN, WITH THE CONTRACTION JOINTS IN ABUTTING CONCRETE PAVEMENT.
 - 4). EXPANSION JOINTS SHALL BE PLACED IN THE BARRIER AT STRUCTURES AND OTHER EXPANSION JOINTS IN ABUTTING CONCRETE PAVEMENT, OVER EXISTING EXPANSION JOINTS IN UNDERLYING CONCRETE PAVEMENT, AND LOCATIONS AS SHOWN ON THE PLANS OR AS DIRECTED BY THE ENGINEER. AT EXPANSION JOINTS, BARRIER SECTIONS SHALL BE 3/4" APART AND THE OPENING FILLED, FOR THE ENTIRE LENGTH AND DEPTH OF THE JOINT WITH 3/4" PREFORMED JOINT FILLER WHICH COMPLIES WITH THE REQUIREMENTS OF SECTION 1042 OF THE STANDARD SPECIFICATIONS. THE FILLER SHALL BE RECESSED 1/4" IN FROM THE SIDES AND TOP OF THE BARRIER.
 - 5). FOR SLIP-FORM CONSTRUCTION, THE 5B2E BARS SHALL BE PLACED AS ONE CONTINUOUS PIECE. THE BARS SHALL LAP A MINIMUM OF 2'-10 1/2".
 - 6). FOR SLIP-FORM CONSTRUCTION, A CONTROL JOINT SHALL BE CUT IN THE BARRIER EVERY 10'-0" AT A MAXIMUM DEPTH OF 1/2".
 - 7). DIAGONAL NO. 4 BARS ONLY REQUIRED WHEN USING SLIP-FORM CONSTRUCTION. DIAGONAL NO. 4 BARS NOT SHOWN IN SECTION VIEW.
 - 8). DEPTH OF GABC TO MATCH ROADWAY BASE, 8" MINIMUM.

TL-3



Andrew Shott
ENGINEERING SUPPORT
RECOMMENDED
DATE: 12/22/2023

32" CONCRETE MEDIAN BARRIER (F-SHAPE)
STANDARD NO. B-27 (2024) SHT. 1 OF 1

REVIEWED
APPROVED
DEPUTY DIRECTOR - DESIGN
CHIEF ENGINEER
22 December 2023
DATE
01/11/2024
DATE