

**SEALANT RESERVOIR DETAIL-
TRANSVERSE AND LONGITUDINAL JOINT**

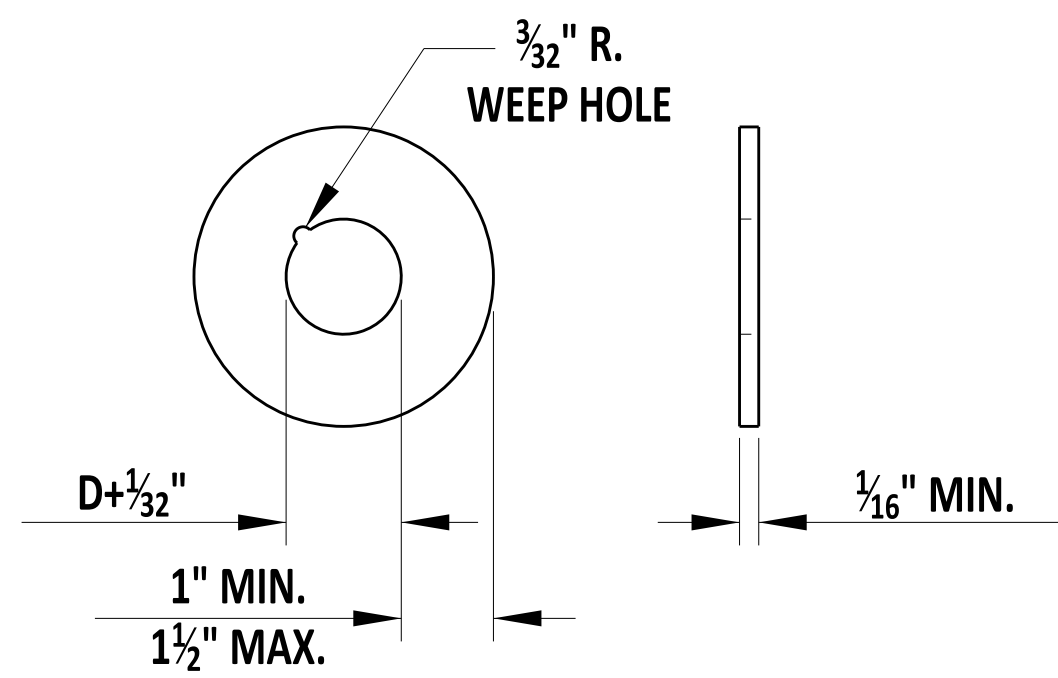

D - DIAMETER (INCLUDING COATINGS, IF ANY.)

GROUT RETENTION DISK

DOWEL & TIE BAR CHART				
SLAB THICKNESS	DOWEL		TIE BAR	
	D	L	D	L
8" < T ≤ 11"	1 1/4"	18"	5/8"	30"
T > 11"	1 1/2"	20"	5/8"	30"

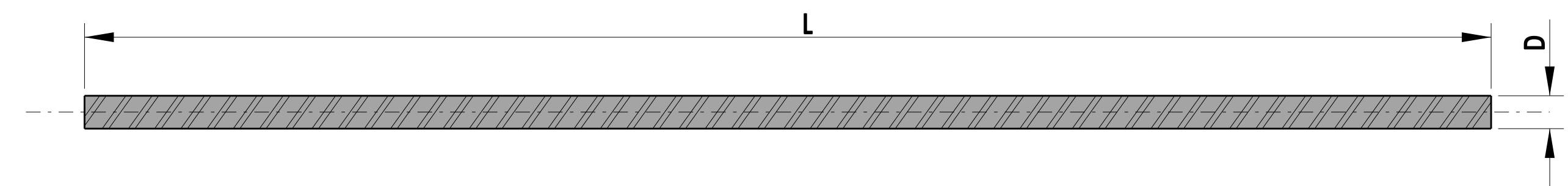

TIE BAR

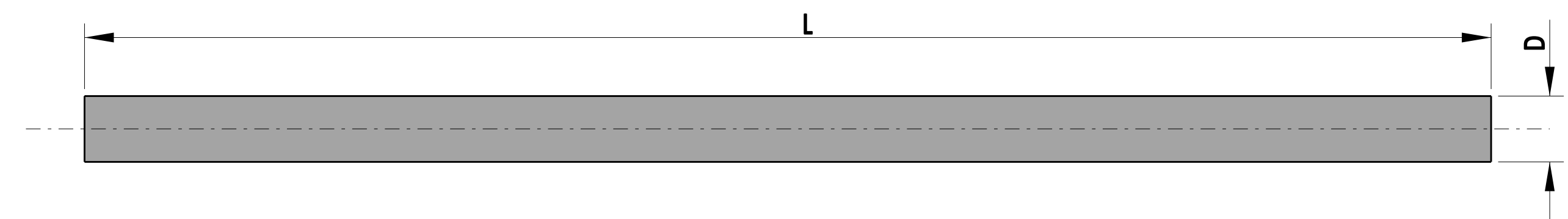

DOWEL BAR

FULL DEPTH PATCH

NOTES:

- 1). AS DIMENSIONED, THE WIDTH OF THE TRANSVERSE SEALANT RESERVOIR IS APPLICABLE WHEN THE TEMPERATURE OF THE PAVEMENT SURFACE IS BETWEEN 60°F AND 80°F. WHEN THE TEMPERATURE IS BELOW 60°F, CUT THE SEALANT RESERVOIR 1/16" WIDER. WHEN THE TEMPERATURE IS ABOVE 80°F, CUT THE SEALANT RESERVOIR 1/16" NARROWER.
- 2). "T" REFERS TO THE "AS BUILT" SLAB THICKNESS.
- 3). THE TOLERANCE ON ALL JOINT SEALANT DETAIL DIMENSIONS SHOWN WITHOUT A RANGE IS PLUS 1/16", MINUS 0".
- 4). CONSTRUCT THE TOP EDGES OF THE CONTACT SURFACES OF THE SEALANT MATERIAL ON BOTH SIDES OF THE JOINT RESERVOIR TO THE SAME ELEVATION.
- 5). SAW CUT TO A DEPTH OF 3" WHEN PCC PAVEMENTS ARE BETWEEN 8" TO 11". SAW CUT TO A DEPTH OF 4" WHEN PCC PAVEMENT IS THICKER THAN 11".



Andrew Short
ENGINEERING SUPPORT
RECOMMENDED
DATE 12/22/2023

FULL DEPTH PATCH, SEALANT, GROUT RETENTION DISK AND DOWEL BARS
STANDARD NO. P-2 (2024)
SHT. 4 OF 6

REVIEWED
APPROVED
DEPUTY DIRECTOR - DESIGN
CHIEF ENGINEER
DATE 22 December 2023
DATE 01/11/2024